

| | | |
|----------------------|-------------------|----------|
| TACTILE EXIT SIGNAGE | N.T.S. | S |
| | 42D-A051-800-DETL | 02.11.14 |

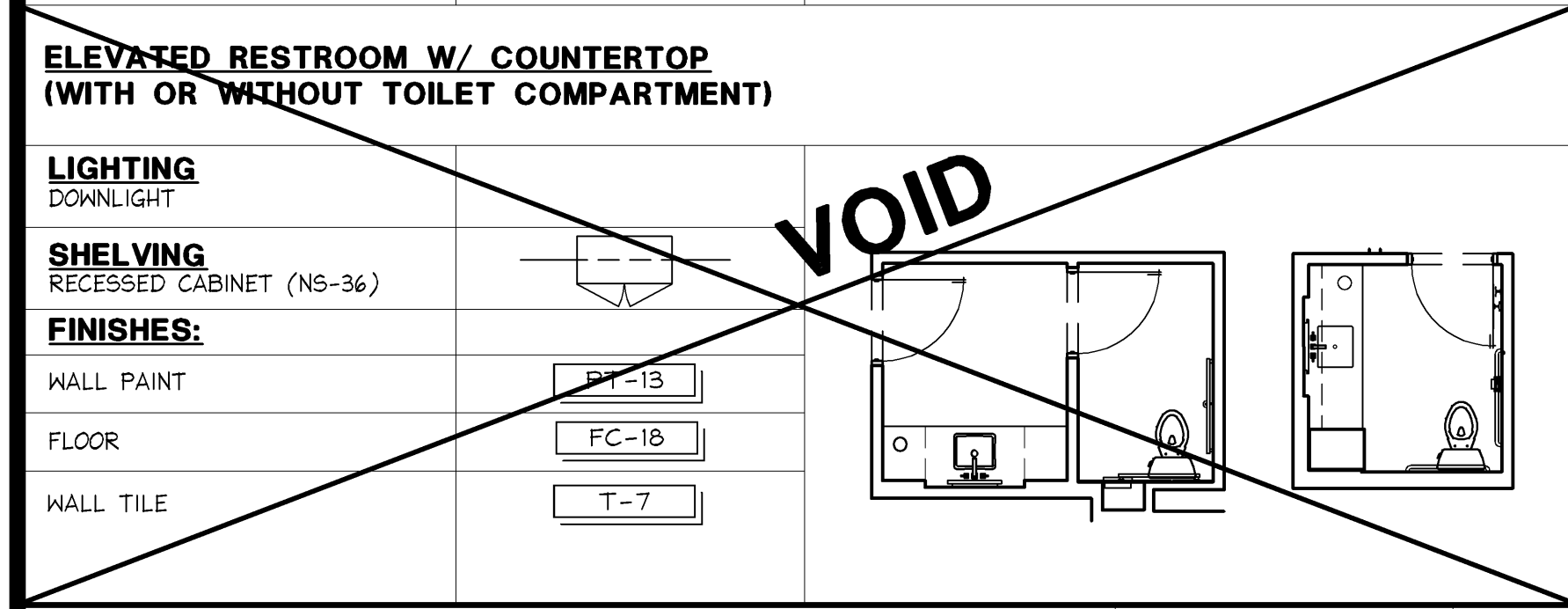
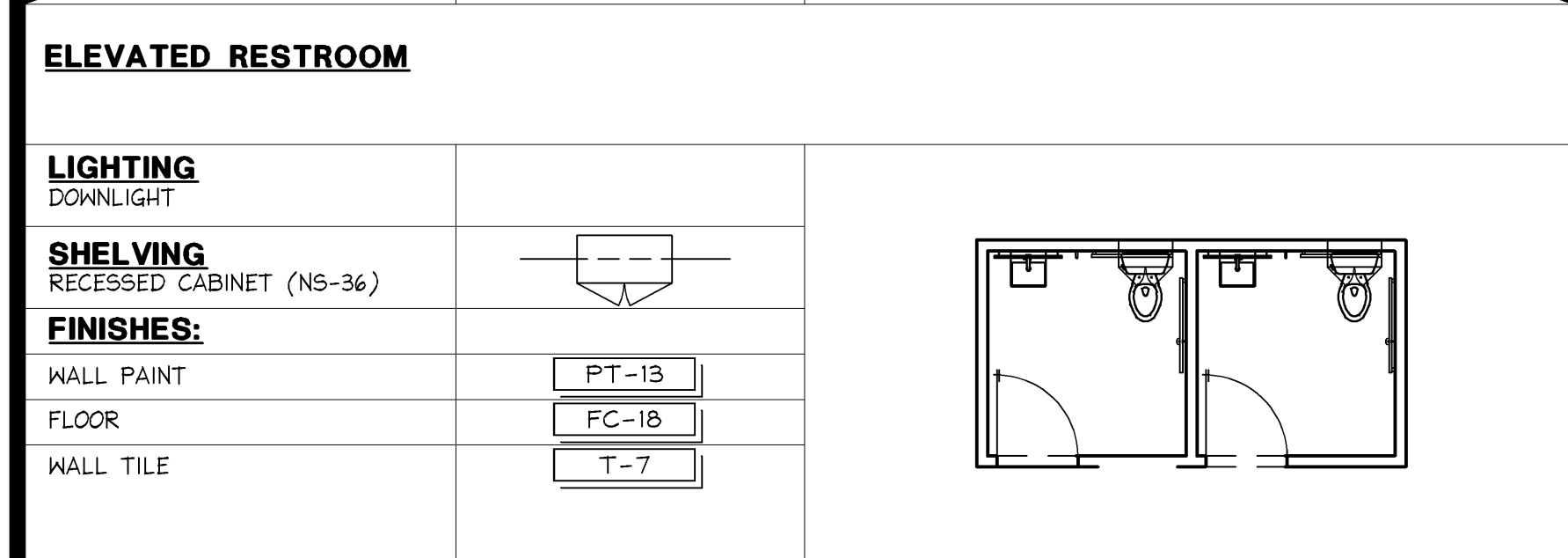
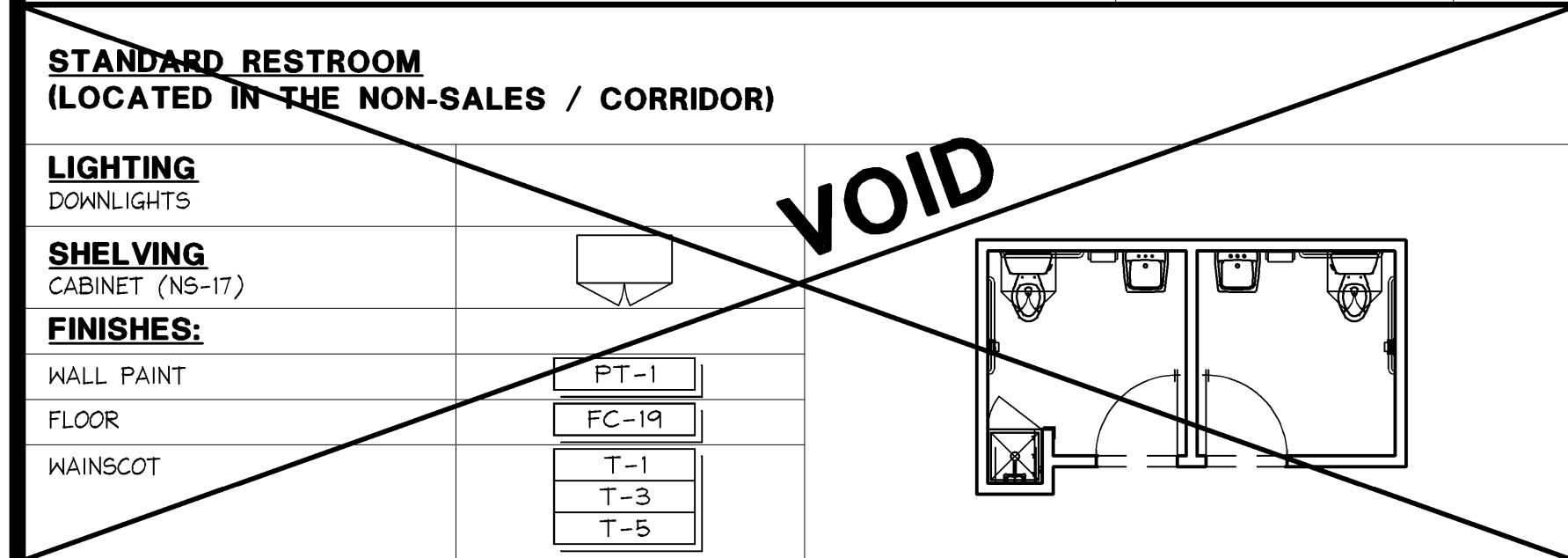

| | | |
|-----------------|-------------------|----------|
| RESTROOM LEGEND | FULL | R |
| | 42L-A051-000-LGND | 10.14.11 |

FINISH PLAN

- TENANT SHALL PROVIDE A FINISH SAMPLE BOARD OR SIMILAR TO THE LANDLORD FOR APPROVAL.
- ALL FLOORING TRANSITIONS MUST BE SMOOTH AND FLUSH. THE USE OF PLASTIC, VINYL, OR RUBBER TRANSITIONS STRIPS IS STRICTLY PROHIBITED. TENANTS MUST UTILIZE A HARD SURFACE TRANSITION.
- TENANT IS REQUIRED TO INSTALL A WATERPROOF MEMBRANE IN ALL WET AREAS (RESTROOMS, KITCHENS, FOOD SERVICES, ETC...) OF THE SPACE. TENANT SHALL USE A 30 MIL POLYETHYLENE CLEAVAGE MEMBRANE (EQUAL TO NOBLESEAL TS) INSTALLED PER MANUFACTURERS RECOMMENDATIONS AND ANSI A108. MEMBRANE MUST BE EXTENDED UP THE WALL A MINIMUM OF 4" OR EQUAL TO HEIGHT OF THE FLOOR BASE.
- NO RUBBER OR VINYL BASE IS PERMITTED IN THE SALES AREA OF THE PREMISES.
- SLAB REQUIREMENTS:
 - SLAB ON GRADE: TENANT'S GENERAL CONTRACTOR SHALL ADVISE THE OPERATION TEAM PRIOR TO ANY SLAB MODIFICATIONS OR REMOVAL. TENANT G.C. SHALL VERIFY THAT WORK SHALL NOT CONFLICT WITH ANY EXISTING STRUCTURAL, UTILITY, OR OTHER UNDER-SLAB CONDITION. (NON DESTRUCTIVE VERIFICATION MAYBE REQUIRED.) ANY DAMAGE OR DOWNTIME CAUSED BY TENANT'S WORK SHALL BE REPAIRED AND REIMBURSED AT TENANT'S EXPENSE.
 - ELEVATED SLABS: TENANT'S GENERAL CONTRACTOR SHALL ADVISE THE OPERATIONS TEAM PRIOR TO ANY SLAB MODIFICATION OR REMOVAL. IF ANY ELEVATED SLAB IS TO BE MODIFIED IN ANYWAY (DRILLED, CORED, OR PENETRATED), TENANT SHALL PROVIDE STAMPED AND CERTIFIED DRAWINGS BY A LICENSED STRUCTURAL ENGINEER CERTIFIED IN THE LOCAL JURISDICTION. ALL PENETRATIONS SHALL BE CORE BORED ONLY. SAW CUTTING, JACK HAMMERING AND TRENCHING IS STRICTLY PROHIBITED. ALL PENETRATIONS SHALL BE SLEEVED, SEALED, FIRE STOPPED, AND WATERPROOFED. THE PENETRATION SLEEVE SHALL EXTEND A MINIMUM OF 4" ON EITHER SIDE OF THE SLAB AND BE LABELED WITH THE REQUIRED NFPA RATING. TENANT G.C. UTILITY, OR OTHER UNDER-SLAB CONDITION. (NONDESTRUCTIVE VERIFICATION MAY BE REQUIRED.) ANY DAMAGE OR DOWNTIME CAUSED BY TENANT'S WORK SHALL BE REPAIRED AND REIMBURSED AT TENANT'S EXPENSE.

REFER TO SPECIFICATIONS DIVISION IX FOR MORE INFORMATION.

PAINT:

- CONTRACTOR TO REVIEW CONSTRUCTION DETAIL SHEETS, FLOOR FINISH PLAN, AND ELEVATIONS FOR HELPFUL CLARIFICATION OF ITEMS AND SURFACES TO BE PAINTED.
- CONTRACTOR IS TO PRIME ALL GYPSUM BOARD.
- ALL METAL SURFACES PAINTED BY PAINT CONTRACTOR ARE TO BE PRIMED WITH A HIGH QUALITY METAL PRIMER AND FINISHED WITH A HIGH QUALITY SEMI GLOSS PAINT. FINISH COATS MUST NOT REVEAL BRUSH MARKS. SPRAY OR APPLY AS NEEDED.
- ALL WOOD SURFACES TO BE PRIMED WITH AN ALL-PURPOSE 100% ACRYLIC LATEX PRIMER AND FINISHED WITH A LATEX BASE PAINT AS SPECIFIED ABOVE.
- FOR EXTERIOR STOREFRONTS: PRIME ALL WOOD WITH ALKYD PRIMER. USE BENJAMIN MOORE MOORCRAFT SUPER SPEC - SEMI GLOSS AS BASE FOR ALL COLORS.
- USING NON-SHRINKING FILLER, FILL AND PUTTY ALL NAIL HOLES, COUNTERSINK SCREWS, BOLTS, CRACKS, ETC. BEFORE APPLYING FINISH.
- WOOD DOORS: SEAL BOTTOMS, TOPS, AND EDGES. SAND ALL WOOD DOORS BEFORE FINISHING.
- NAIL WOOD TRIM BOARDS IN LEAST CONSPICUOUS LOCATIONS. SET AND FINISH SMOOTH.
- SAND ALL WOOD SURFACES SMOOTH AND EVEN BEFORE PAINTING.
- SAND ENAMELED FINISHES APPLIED TO WOOD OR METAL BETWEEN COATS WITH FINE SANDPAPER TO PRODUCE SMOOTH AND EVEN FINISH.
- MAKE FINISH WORK UNIFORM, SMOOTH, FREE OF RUNS, SAGS, DEFECTIVE BRUSHING AND CLOGGING. MAKE EDGES OF PAINT ADJOINING OTHER MATERIALS OR COLORS SHARP AND CLEAN WITHOUT OVERLAPPING.

FLOOR COVERING:

- CERAMIC TILES ARE TO BE INSTALLED MAINTAINING A CONSISTENT GROUT JOINT WIDTH THROUGHOUT THE MAXIMUM GROUT JOINT WIDTH IN SALES AREA IS TO BE 1/8", U.O.N.
- G.C. TO PROVIDE ZINC DIVIDER STRIP AT WOOD TO MARBLE, WOOD TO COCOA MAT, AND AT THE NON-SALES DOOR BETWEEN FLOOR FINISHES, WHERE APPLICABLE.

TILE AND GROUT SEALANT:

- APPLY SII IMPREGNATOR SEALER TO ALL SURFACES PRIOR TO GROUTING USING A MIRA BRUSH APPLICATOR OR A CLEAN, WHITE COTTON TOWEL. APPLY SUFFICIENT AMOUNT TO MOISTEN ALL SURFACES WITHOUT SATURATING JOINTS. AFTER SEALER STANDS FOR 3-5 MINUTES, BUFFING WITH A CLEAN, DRY TOWEL IS IMPORTANT. ALLOW TO CURE FOR 24 HOURS BEFORE GROUTING.
- AFTER GROUTING, REMOVE ALL EXCESS GROUT AND RESIDUE. ALLOW TO DRY FOR 24 HOURS. IF RESIDUE OR HAZE REMAINS, USE GROUT, CONCRETE AND FILM REMOVER, FOLLOWING LABEL INSTRUCTIONS.
- APPLY SII IMPREGNATOR SEALER TO ALL GROUT WITH A THIN PAINT BRUSH OR THE APPLICATOR TIP. REMOVE ANY SEALER FROM PRE-FINISHED SURFACES BEFORE SEALER DRIES. FOR LARGER JOBS, GROUT MAY BE SEALED BY TREATING ENTIRE AREA, INCLUDING MARBLE, A SECOND TIME. ENSURE SEALER DOES NOT PUDDLE.
- SEALER WILL BE DRY TO THE TOUCH IN 45-60 MINUTES AND MAY BE USED FOR NORMAL FOOT TRAFFIC. IT IS RECOMMENDED TO KEEP SEALED SURFACES DRY AND FREE FROM STAIN FOR 72 HOURS.

| | | |
|--------------|-------------------|----------|
| FINISH NOTES | FULL | M |
| | 42N-A051-M00-NOTE | 10.14.11 |

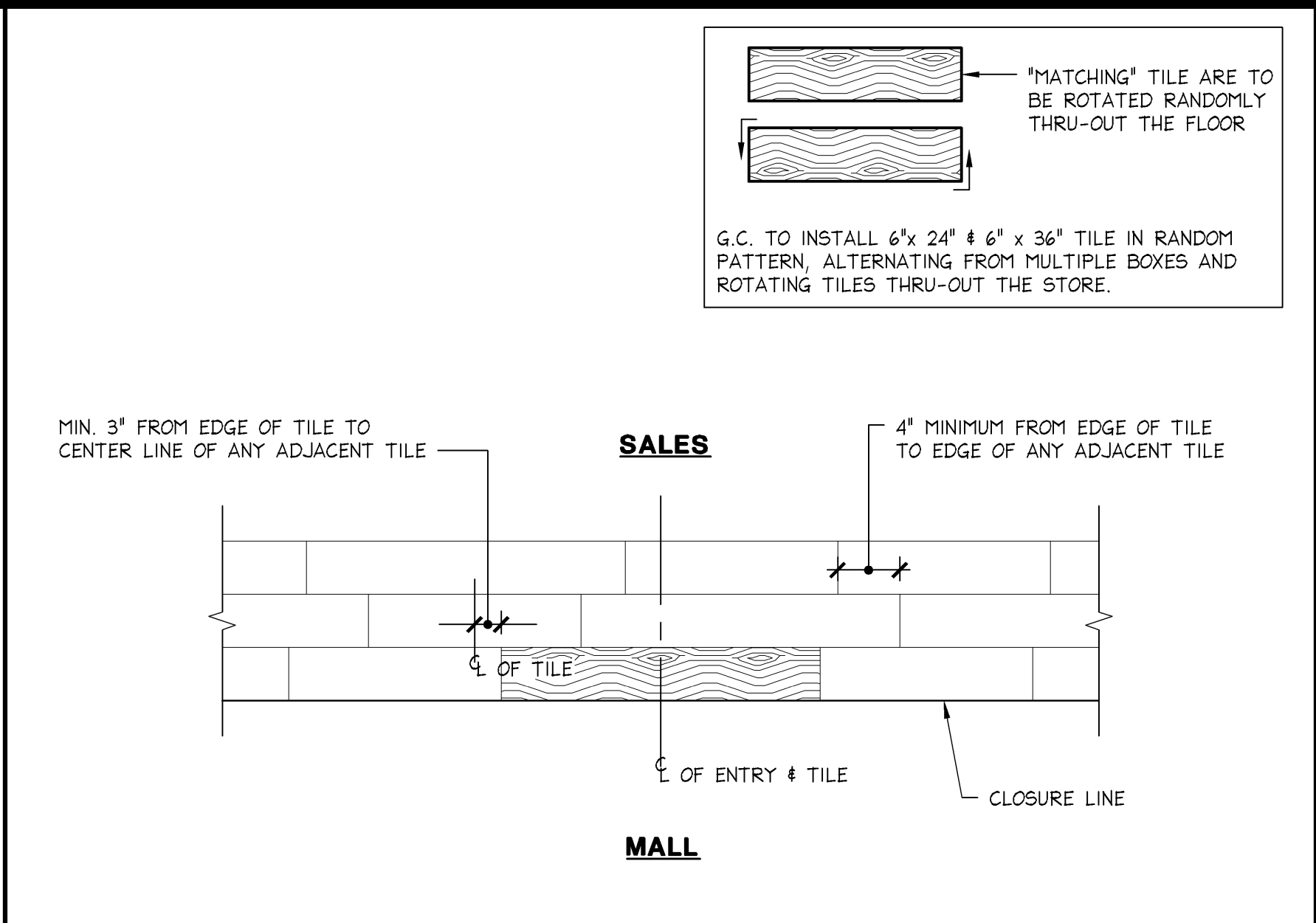

| | | |
|--------------------------------------|-------------------|----------|
| FC-18 CROSSVILLE TILE LAYOUT @ ENTRY | 3/4" = 1'-0" | H |
| | 42D-A051-H00-DETL | 06.03.10 |

FINISH PLAN NOTES

- REFER TO SHEET A05.1 FOR STOREFRONT FINISHES
- REFER TO SHEET A00.2 FOR FINISH SCHEDULE
- PAIN ALL EXPOSED WALLS & CEILINGS PT-1 U.O.N.
- PAIN ALL NON-SALES DOORS PT-5
- MITER ALL OUTSIDE CORNERS OF WALL BASE - COPE ALL INSIDE CORNERS
- TILE FLOORING TO BE SET BEFORE WOOD BASE. SCRIBE WOOD BASE TO TOP OF FLOOR AS BEST POSSIBLE AND CAULK GAPS.

| | | |
|-------------------|-------------------|----------|
| FINISH PLAN NOTES | FULL | D |
| | 42N-A051-D00-NOTE | 08.31.04 |

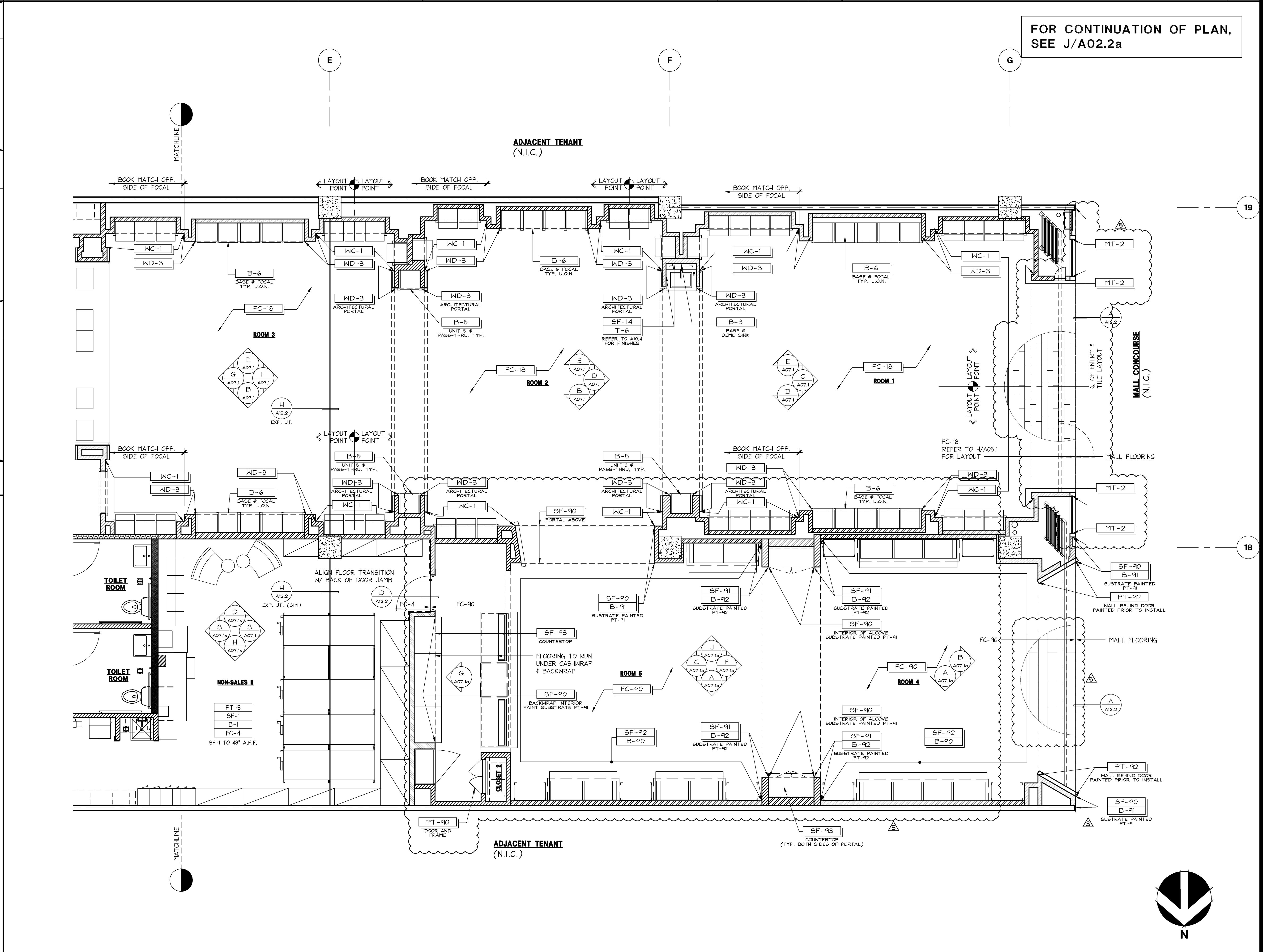

| | | |
|--------------------------|-------------------|----------|
| FLOOR & WALL FINISH PLAN | 1/4" = 1'-0" | A |
| | 42P-A051-A00-PLAN | 10.14.11 |

SHREMSHOCK
Shremshock Architects, Inc.
6150 S. Sunbury Rd., Westerville, OH 43081
T: 614 545 4550 | F: 614 545 4555 | shremshock.com
Gerald S. Shremshock, Architect
Timothy J. Shremshock, Architect

ELITE CONSTRUCTION GROUP
LAKE JACKSON, TX
PHONE: 979-284-0712
NOTE: THESE PRINTS HAVE BEEN REDUCED BY 50 PERCENT. SCALE WILL BE 50 PERCENT OF WHAT IS NOTED ON PLANS

Limited brands
LIMITED STORE PLANNING, INC.
d/b/a STORE DESIGN & CONSTRUCTION
Three Limited Parkway • Columbus, Ohio 43230
Telephone: 614.415.7000 • Fax: 614.415.7349

PROJECT INFORMATION:

BATH & BODY WORKS
THE GALLERIA II
SPACE INDUSTRIES RD.
HOUSTON, TX 77056

REVISIONS:

| NO. | REVISION | DATE |
|-----|--|----------|
| 1 | BUILDING DEPARTMENT COMMENTS | 04/11/14 |
| 2 | BUILDING DEPARTMENT COMMENTS | 05/07/14 |
| 3 | DESIGN CHANGES / LANDLORD COMMENTS / MASTERS UPDATES | 05/28/14 |
| 4 | DESIGN CHANGES | 06/27/14 |
| 5 | DESIGN CHANGES | 07/24/14 |

DATE ISSUED: 3/7/14
DESIGNED BY: SB
DRAWN BY: JLH
CHECKED BY: RHW

FLOOR & WALL FINISH PLAN

DRAWING NUMBER:
A05.1